



**T&S BRASS AND BRONZE WORKS, INC.**  
 2 Saddleback Cove / P.O. Box 1088  
 Travelers Rest, SC 29690

Model No.  
**B-1433-01M-QDS**

Item No.

Travelers Rest, SC: 800-476-4103 • Simi Valley, CA: 800-423-0150 • Fax: 864-834-3518 • www.tsbrass.com

This Space for Architect/Engineer Approval

Job Name \_\_\_\_\_ Date \_\_\_\_\_  
 Model Specified \_\_\_\_\_ Quantity \_\_\_\_\_  
 Customer/Wholesaler \_\_\_\_\_  
 Contractor \_\_\_\_\_  
 Architect/Engineer \_\_\_\_\_

**B-0963**  
 Continuous Pressure  
 Vacuum Breaker w/  
 Integral Check Valve

3/8" NPT x 36"  
 Flexible Water  
 Connector  
 To Hose Reel

Stainless Steel  
 Quick Disconnect

3/8" NPT x 40" Riser

Control Valve

(2) B-0109-07  
 Wall Brackets

3/8" NPT x 16" Riser

3 11/16"  
 [94mm]

12 3/16"  
 [309mm]

Ø 2" [51mm]  
 Flanges w/  
 1/2" NPT  
 Female Inlets

8"  
 [203mm]

Adjustable From  
 7 3/4" to 8 1/4"  
 [197mm to 210mm]



Open Coated  
 Hose Reel  
 w/ 35'  
 of 3/8"  
 Hose

**B-0107**  
 1.42 GPM  
 Spray Valve w/  
 AW-5B  
 Stainless  
 Steel QD  
**EPAct 2005  
 Compliant**

Ø 1/2"  
 [13mm]  
 Typ

6 7/16"  
 [164mm]

5 1/2"  
 [139mm]

2 3/8"  
 [60mm]

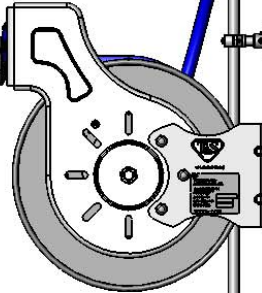

63 5/16"  
 [1609mm]

17 3/4"  
 [451mm]

5 1/4"  
 [133mm]

3/4"  
 [19mm]

1/2"  
 [13mm]  
 Typ

**Product Specifications:**  
 Open Coated Hose Reel w/ 35' of 3/8" Hose, Two Spray Valves  
 w/ Quick Disconnects, Vacuum Breaker, 3/8" NPT Flexible  
 Water Connector, 8" Wall Mount Mixing Faucet & Control Valve

**Product Compliance:**  
 NSF 61 Exempt (Non-Potable)  
 EPAct 2005 (B-0107)  
 EPAct 2005 Non-Compliant (EB-2322)  
 ASSE 1056 (VB)



# T&S BRASS AND BRONZE WORKS, INC.

2 Saddleback Cove / P.O. Box 1088  
Travelers Rest, SC 29690

Model No.

**B-1433-01M-QDS**

Item No.

Travelers Rest, SC: 800-476-4103 • Simi Valley, CA: 800-423-0150 • Fax: 864-834-3518 • www.tsbrass.com

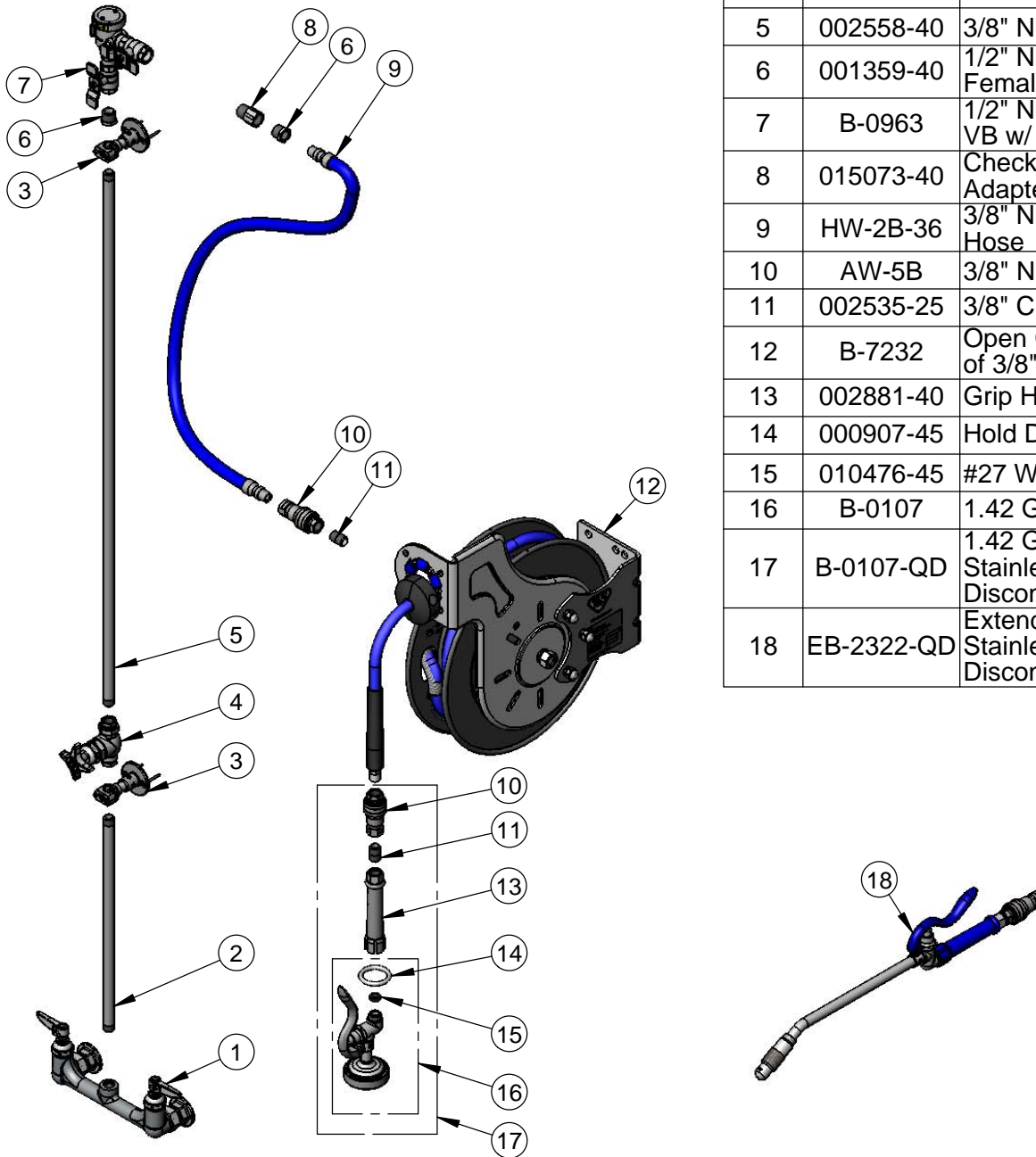

ITEM NO.	SALES NO.	DESCRIPTION
1	002832-40	8" Wall Mount Mixing Faucet
2	000368-40	3/8" NPT x 16" Riser
3	B-0109-07	Wall Bracket
4	0RK3	Control Valve
5	002558-40	3/8" NPT x 40" Riser
6	001359-40	1/2" NPT Male x 3/8" NPT Female Hex Bushing
7	B-0963	1/2" NPT Continuous Pressure VB w/ Integral Check Valve
8	015073-40	Check Valve w/ 1/2" NPT Adapter
9	HW-2B-36	3/8" NPT x 36" Flexible Water Hose
10	AW-5B	3/8" NPT Quick Disconnect
11	002535-25	3/8" Close Nipple
12	B-7232	Open Coated Hose Reel w/ 35' of 3/8" Hose
13	002881-40	Grip Handle, 3/8" NPT
14	000907-45	Hold Down Ring
15	010476-45	#27 Washer
16	B-0107	1.42 GPM Spray Valve
17	B-0107-QD	1.42 GPM Spray Valve w/ Stainless Steel Quick Disconnect
18	EB-2322-QD	Extended Wand Spray Valve w/ Stainless Steel Quick Disconnect

**Product Specifications:**

Open Coated Hose Reel w/ 35' of 3/8" Hose, Two Spray Valves w/ Quick Disconnects, Vacuum Breaker, 3/8" NPT Flexible Water Connector, 8" Wall Mount Mixing Faucet & Control Valve

**Product Compliance:**

NSF 61 Exempt (Non-Potable)  
EPAAct 2005 (B-0107)  
EPAAct 2005 Non-Compliant (EB-2322)  
ASSE 1056 (VB)